

Rockfon® Plenum Barrier Board

Features & Benefits

- Improves sound isolation and privacy between rooms
- Installs quickly above interior partitions
- Lightweight and easy to cut
- Conforms around pipes and ducts
- Expands and contracts with deflection

Applications

- Combine with Acoustic ceilings
- Private offices & meeting rooms
- Patient, exam & treatment rooms
- Classrooms
- Premanufactured/
modular rooms
- New construction or post
occupancy remediation

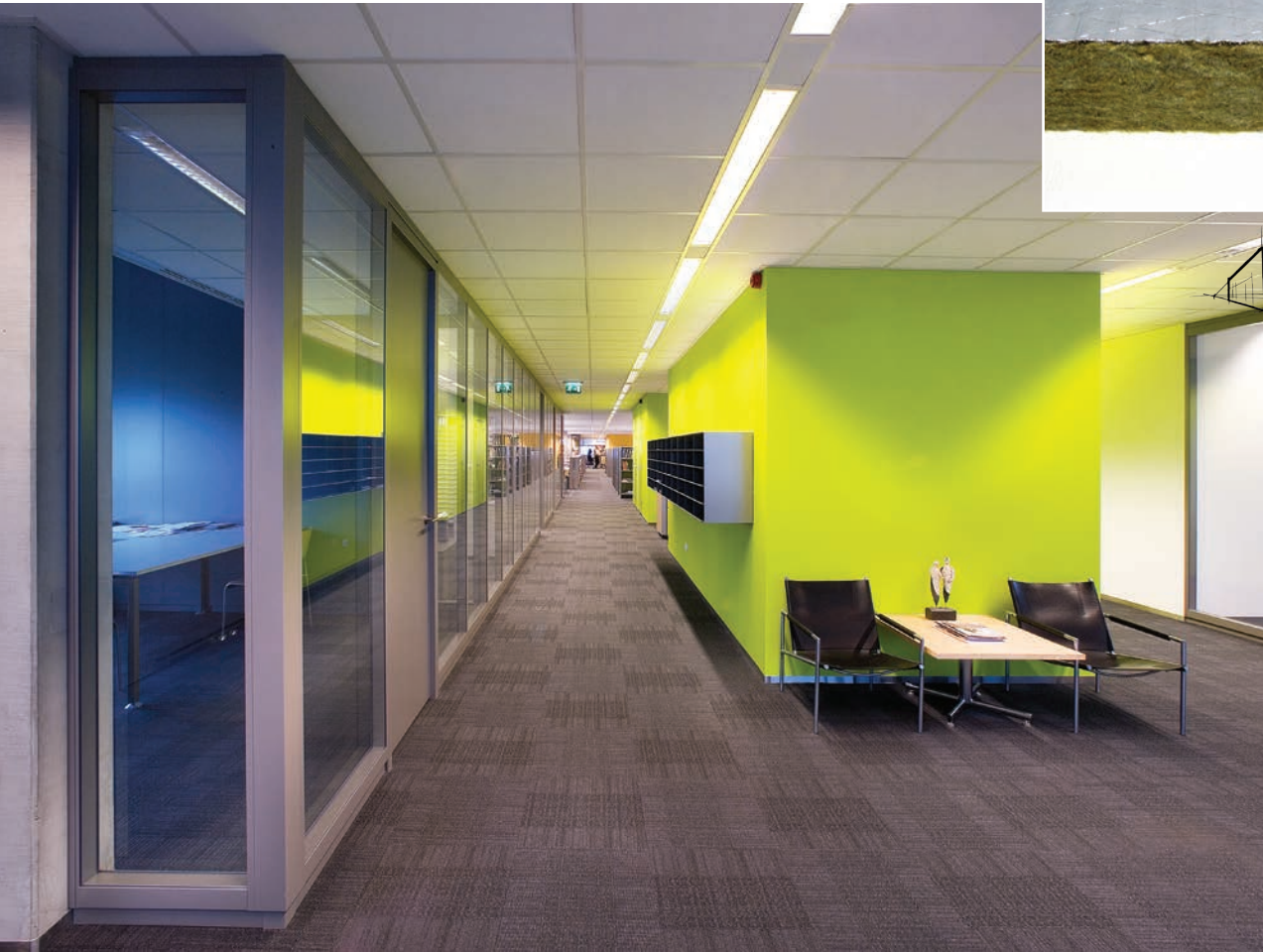
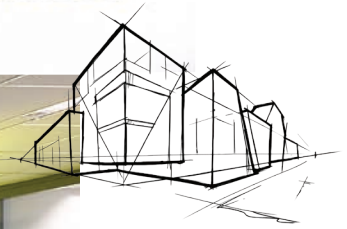
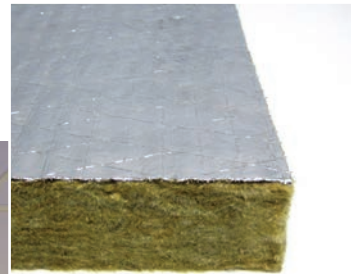

Rockfon ceiling tiles are manufactured using advanced stone wool technology. All stone wool tiles benefit from:



**High Acoustic
Absorption**



**Class A Fire Rated
Performance**



**Moisture and Sag
Resistance**

Rockfon® Plenum Barrier Board

LEED® V4 HIGHLIGHTS

Materials and Resources (MR)

- Waste Management Planning -
- Interiors Life Cycle Impact Reduction ✓
- Environmental Product Declarations ✓
- Sourcing of Raw Materials ✓
- Material Ingredients ✓
- Waste Management -

Indoor Environmental Quality (EQ)

- Low-Emitting Materials ✓
- Interior Lighting -
- Acoustic Performance ✓

Recycled Content: up to 40%

Edge designation	Item number	Board size	lbs/sqft	sqft/pallet	Fire Class
Square 	7900	2' x 4' x 1-1/2"	1	528	A

Material

Stone wool (mineral wool) semi-rigid insulation board with reinforced aluminum foil facing adhered on one side

Performance



Without Plenum Barrier Board

- Blocking level 20-35 STC/CAC/NIC
- Test report NGC-6016008
- Noncompliance with most standards
- Avoid this design approach

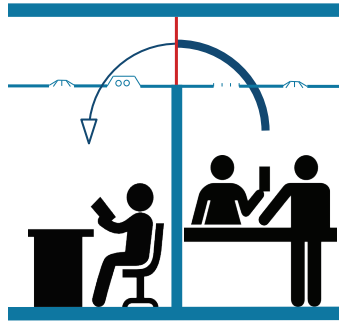

With 1-Layer Plenum Barrier Board

- Blocking level 40 STC/CAC/NIC*
- Test report NGC-6016016
- Compliance with some standards
- Use over walls with standard doors and large areas of glass

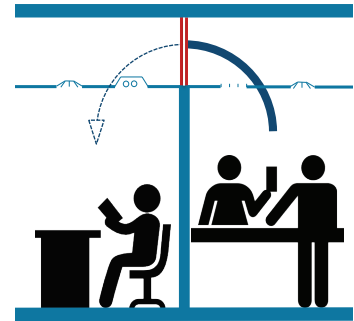

With 2-Layer Plenum Barrier Board

- Blocking level 50+ STC/CAC/NIC*
- Test report NGC-6016017
- Compliance with most standards
- Use over walls without doors and glass

Note:

STC: Sound Transmission Class ASTM E90 / ASTM E413
 CAC: Ceiling Attenuation Class ASTM E1414 / ASTM E413
 NIC: Noise Isolation Class ASTM E336 / ASTM E413

* Blocking level results from combining ceiling performance with plenum barrier performance. Ceiling should be standard, 5/8" thick (or thicker), stone wool ceiling panels in suspension grid. The construction of the interior partition should have equal or greater sound blocking performance.

Rockfon® is a registered trademark
of the ROCKWOOL Group.

2019 | Subject to alterations in range and product technology without prior notice. Rockfon accepts no responsibility for printing errors.
© ROCKWOOL International A/S 2018. All rights reserved. ® denotes a trademark that is registered in the United States of America.

052319

Rockfon

4849 S. Austin Ave.
Chicago, IL 60638 USA

Tel. +1-800-323-7164
Fax. +1-800-222-3744
www.rockfon.com

