



Installation Instructions Ceiling Mounted Deflection Bead



**Please read entire instruction
before proceeding.**

Improper installation will void
any applicable warranty.

STOCK NUMBER	LENGTH	PCS PER BOX
9240	10'	40
9242	12'	40

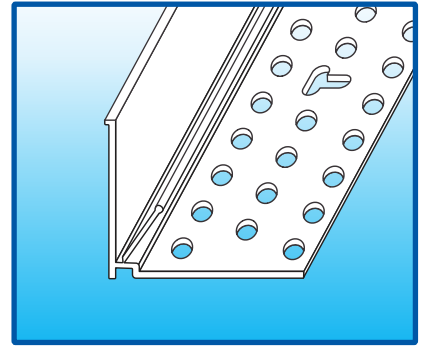

Installation

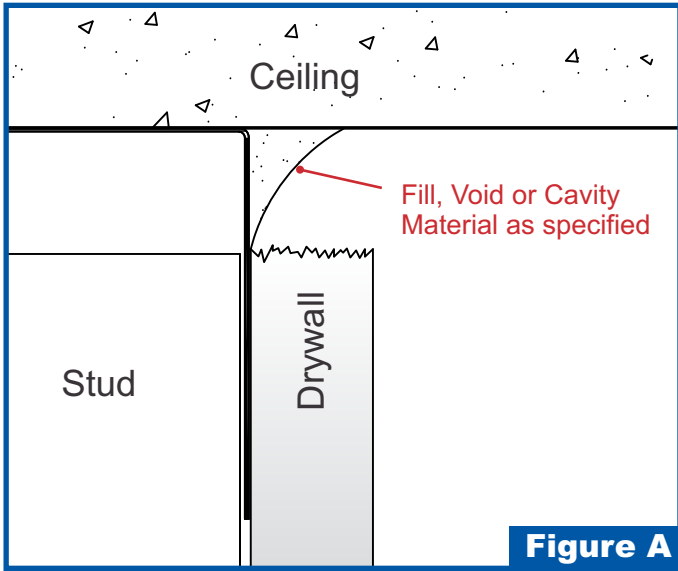
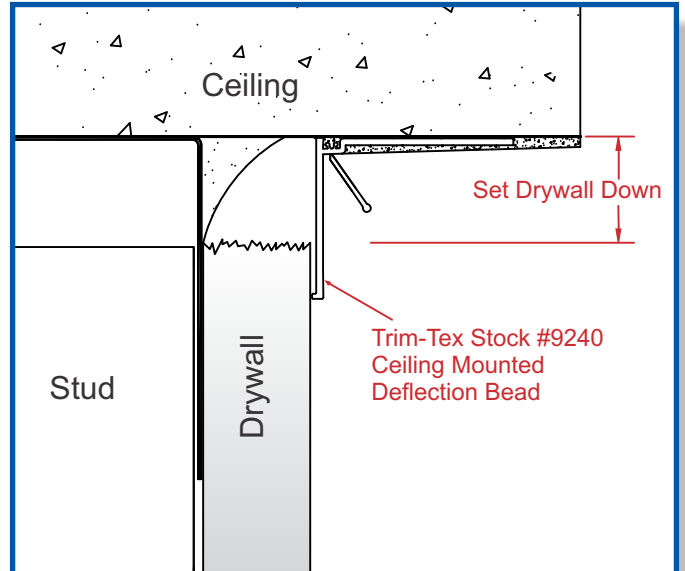

Figure A



Step 1. Hang your drywall with no more than 7/8" from the ceiling or as specified by your architect.

Step 2. Fill the void shown in **Figure A** with fire caulk or materials specified by the architect.

Step 3. Snip your bead to length and dry fit to the ceiling for accurate installation.

Step 4. Apply a narrow layer of *Taping Joint Compound* to the ceiling. Be sure to add Trim-Tex Mud-Max (#850) to the setting and base coat of compound. Embed the deflection bead into the compound and press into place with a taping knife. Coat the bead as needed.

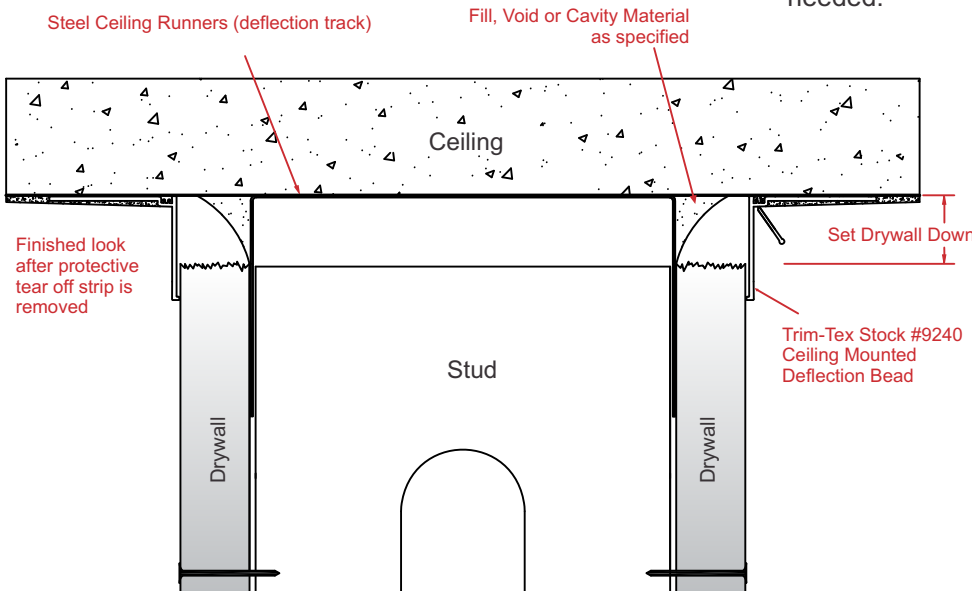

Step 5. Prior to the final sanding remove the tear away strip for a clean and crisp finish.

DO NOT USE SETTING TYPE JOINT COMPOUNDS (HOT MUD)

Trim-Tex Mud Max
boosts the performance
and strength of any
drywall compound.

