

ENVIROWALL

PARTITION SYSTEMS LIMITED

SYSTEM "48"-I PROGRESSIVE-BATTENLESS MOVEABLE WALL DETAILS FOR 12.7mm(1/2")THICK x 1219.2mm(48")WIDE PANELS

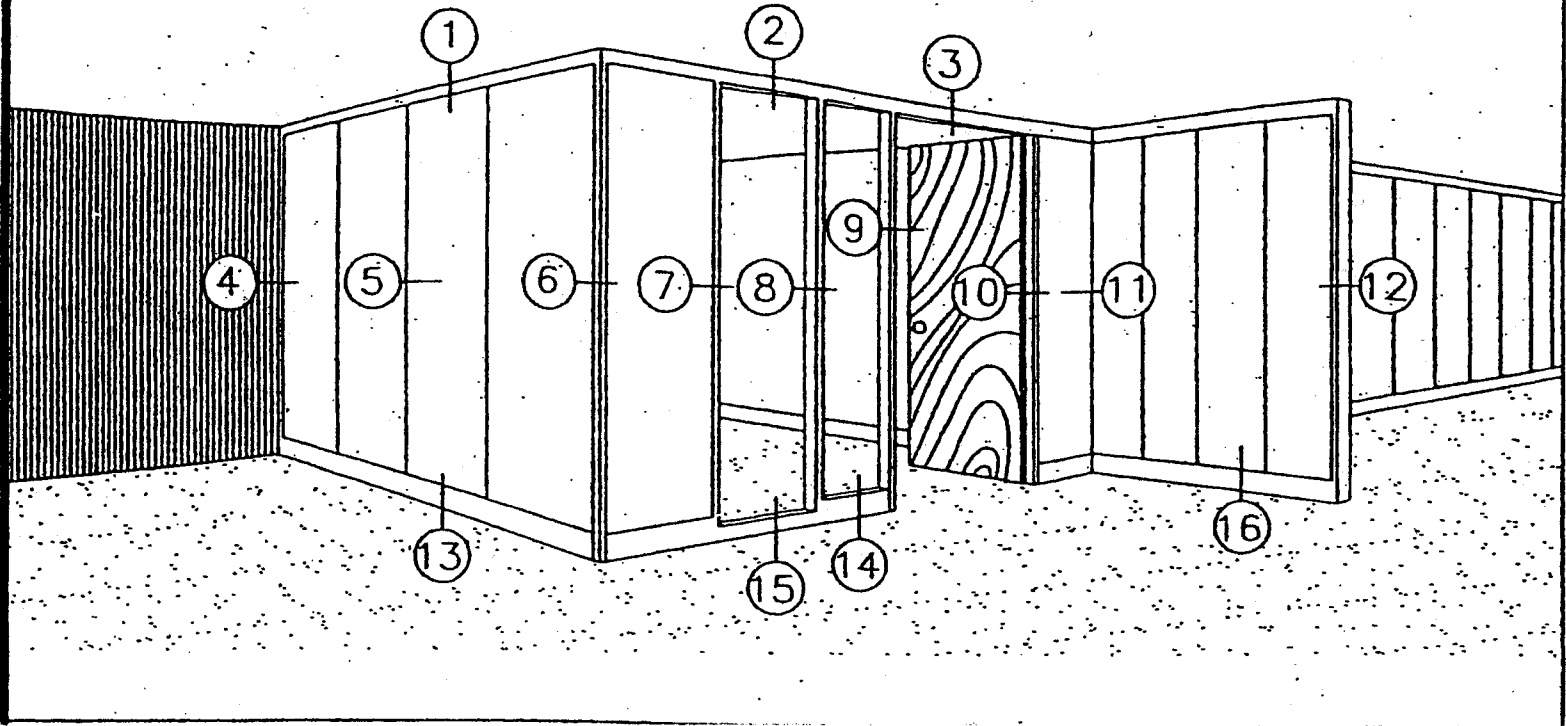

1. HEAD DETAIL

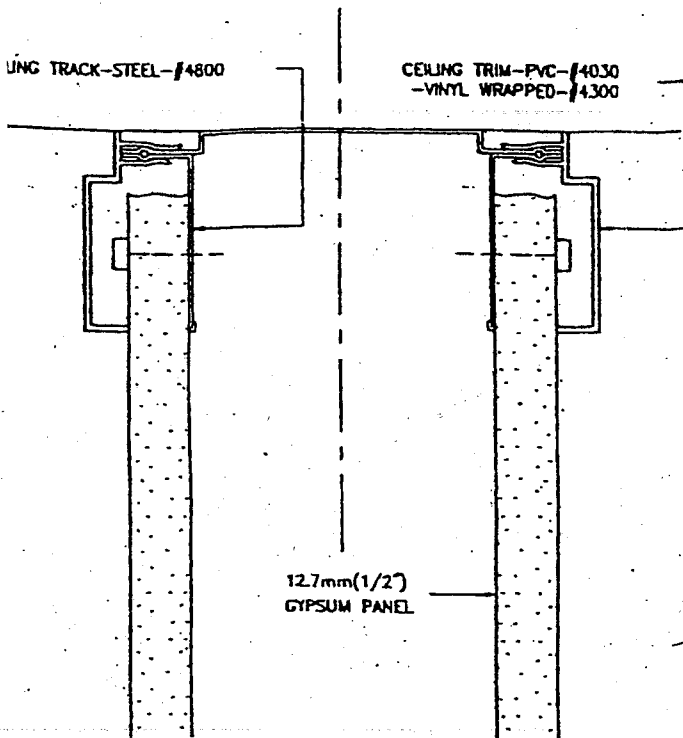

2. CEILING HEIGHT GLAZING HEAD

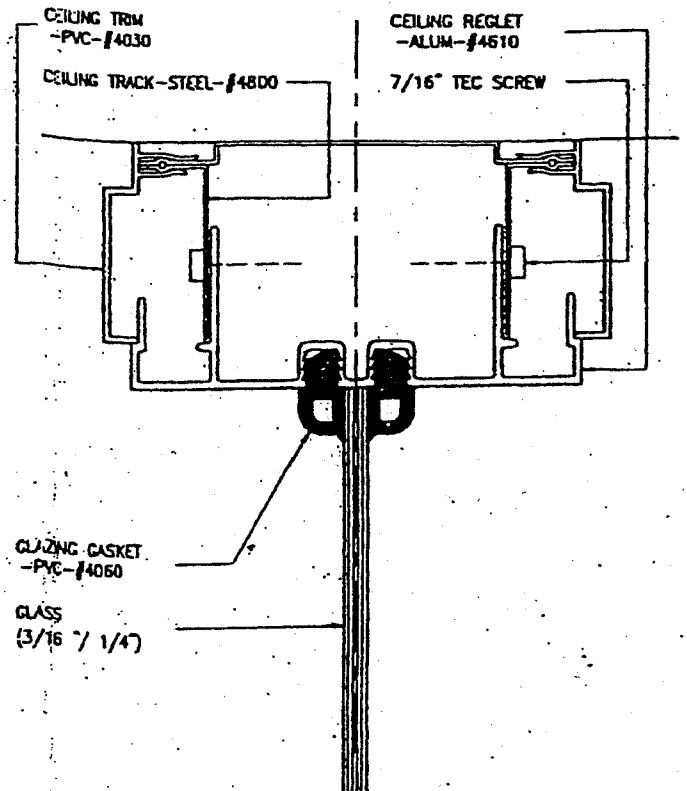

3. CEILING HEIGHT DOOR HEAD

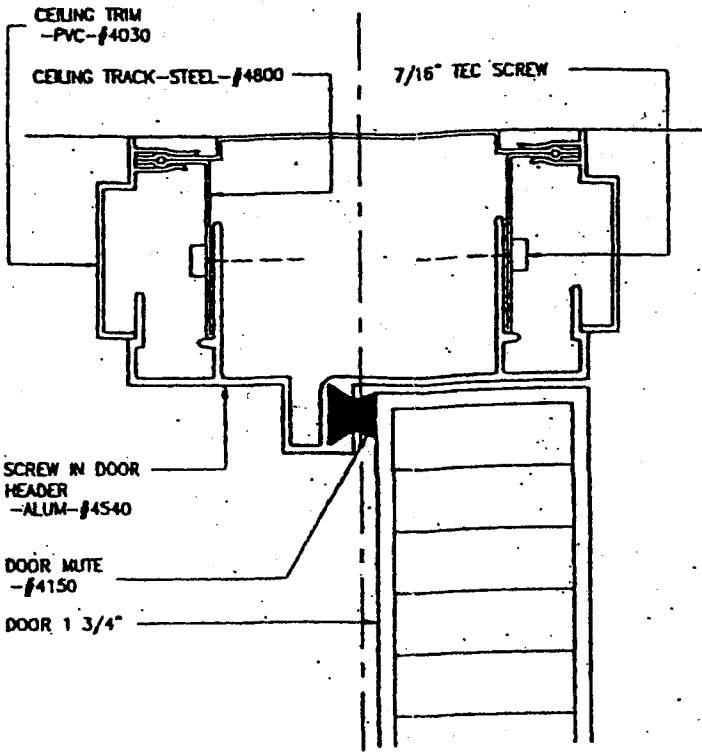

4. TERMINATION

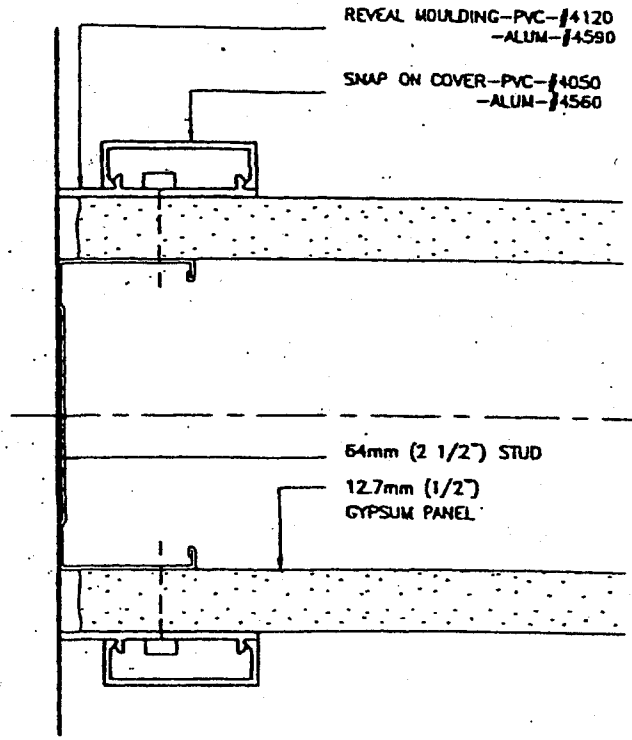

NOTE: DRIVE IN INSIDE CORNER-PVC-#4080
MAY BE USED

5. PARTITION JOINT

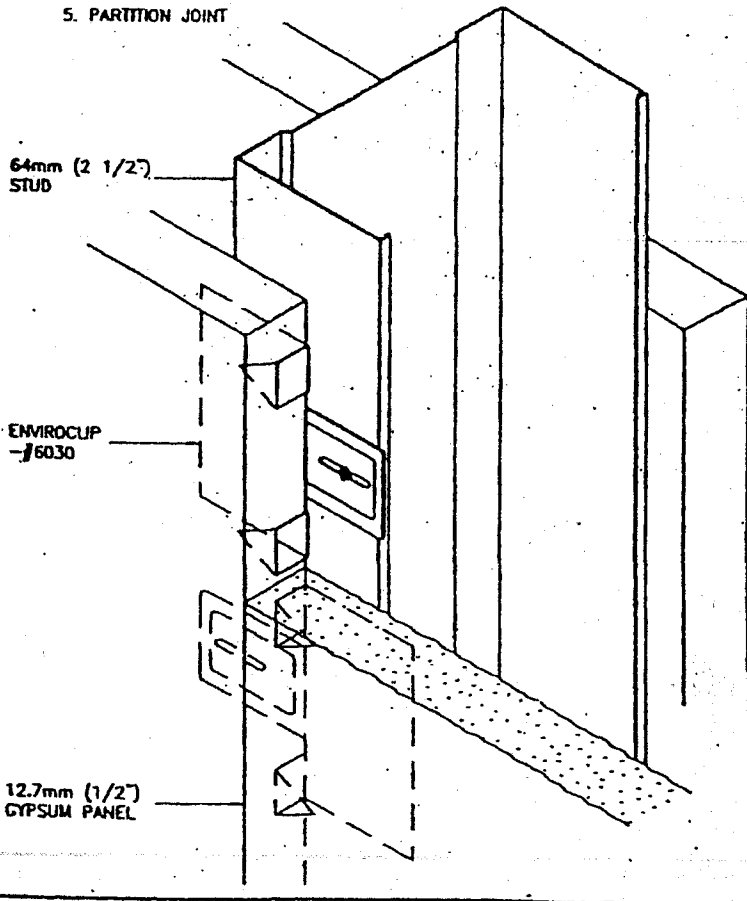

6. OUTSIDE CORNER
*NEW DETAIL

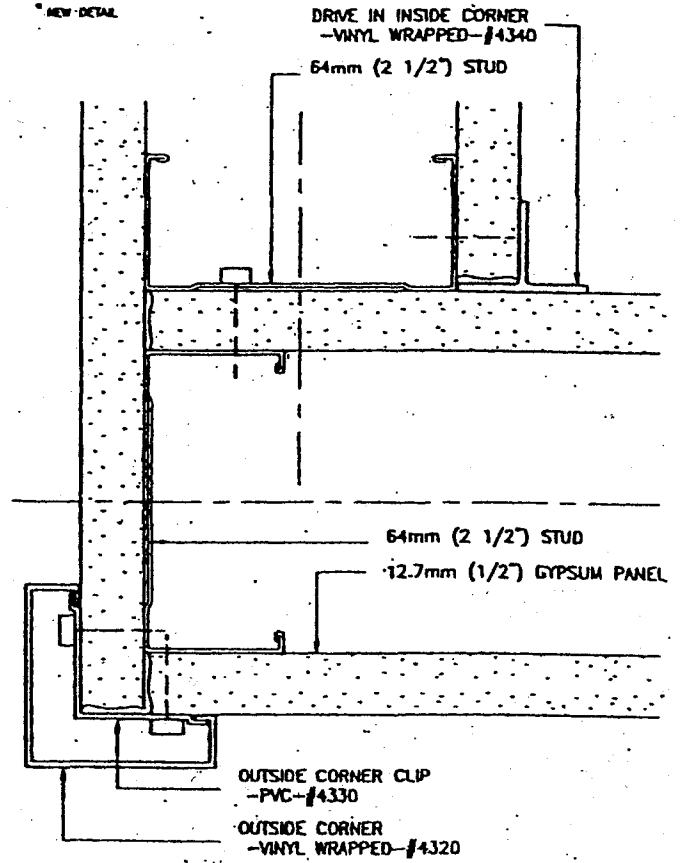

6. ALTERNATE OUTSIDE CORNER

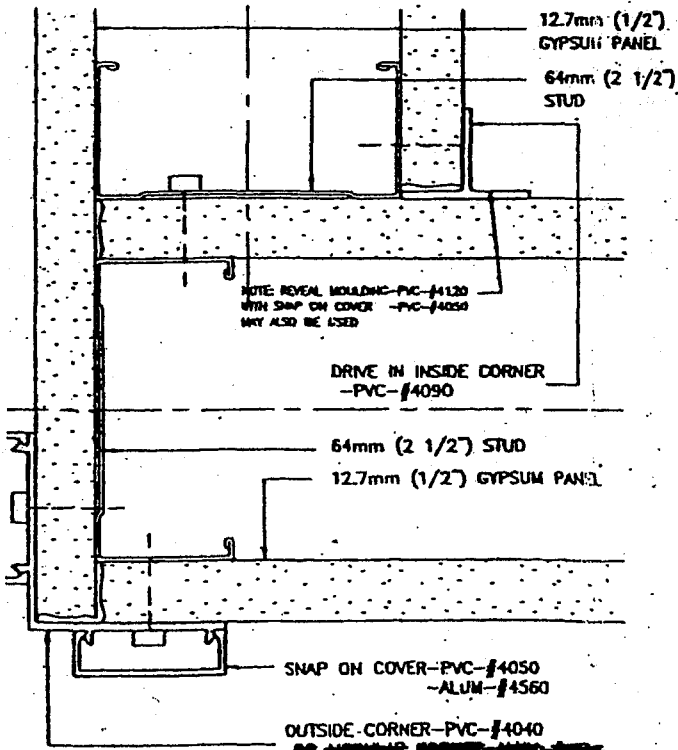

7. GLAZING JAMB

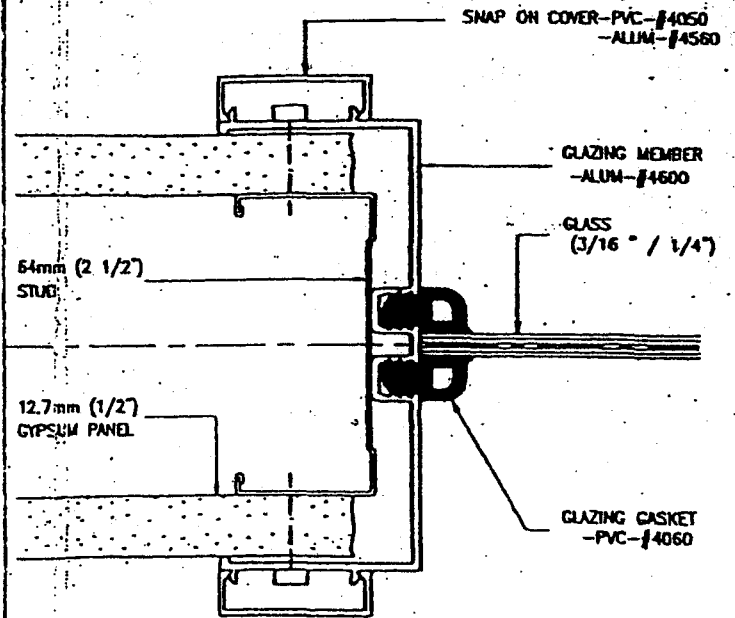

8. MULLION

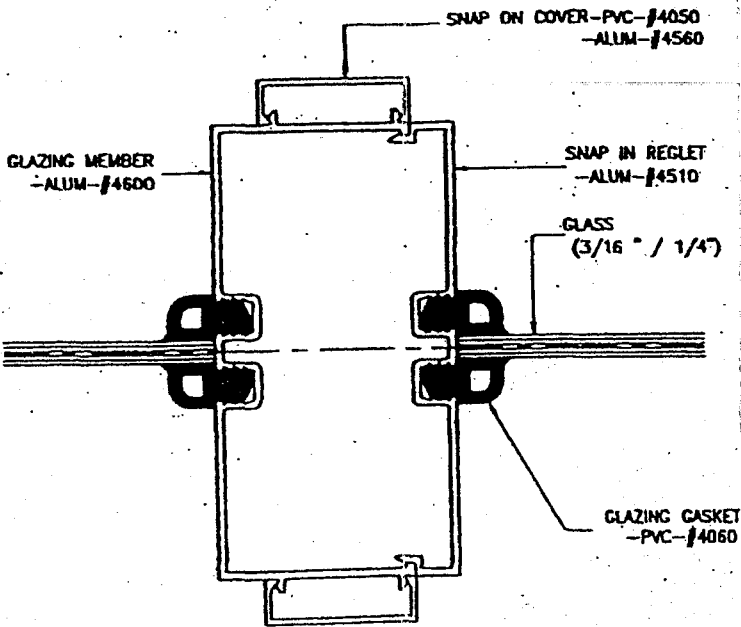

NOTE: 2 SUPPORT BRACKETS REQUIRED-#9010

9. DOOR GLAZING

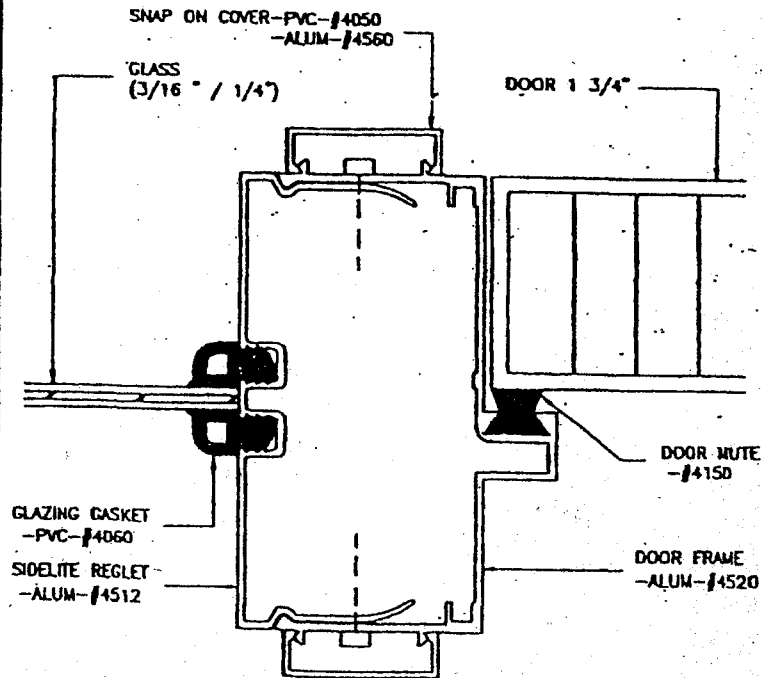

10. DOOR JAMB

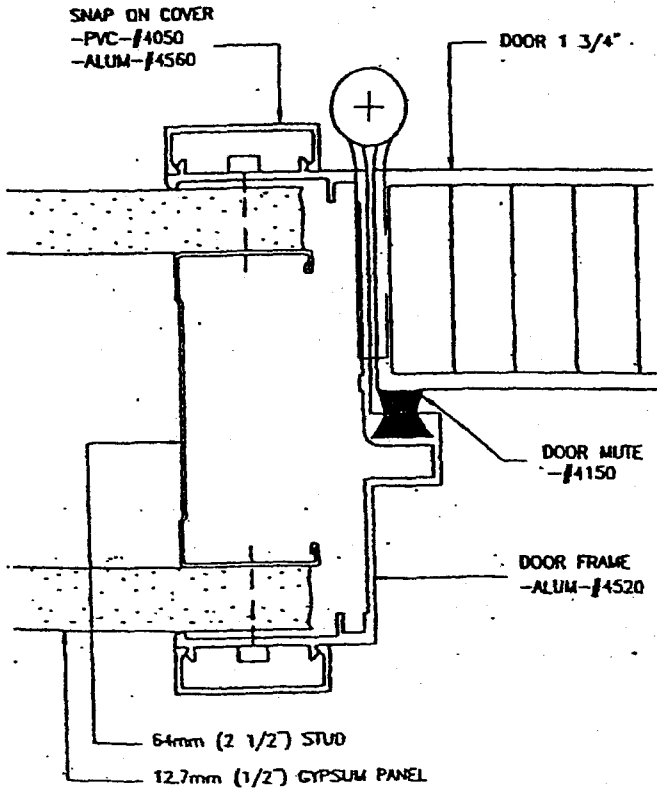

11. INTERSECTION

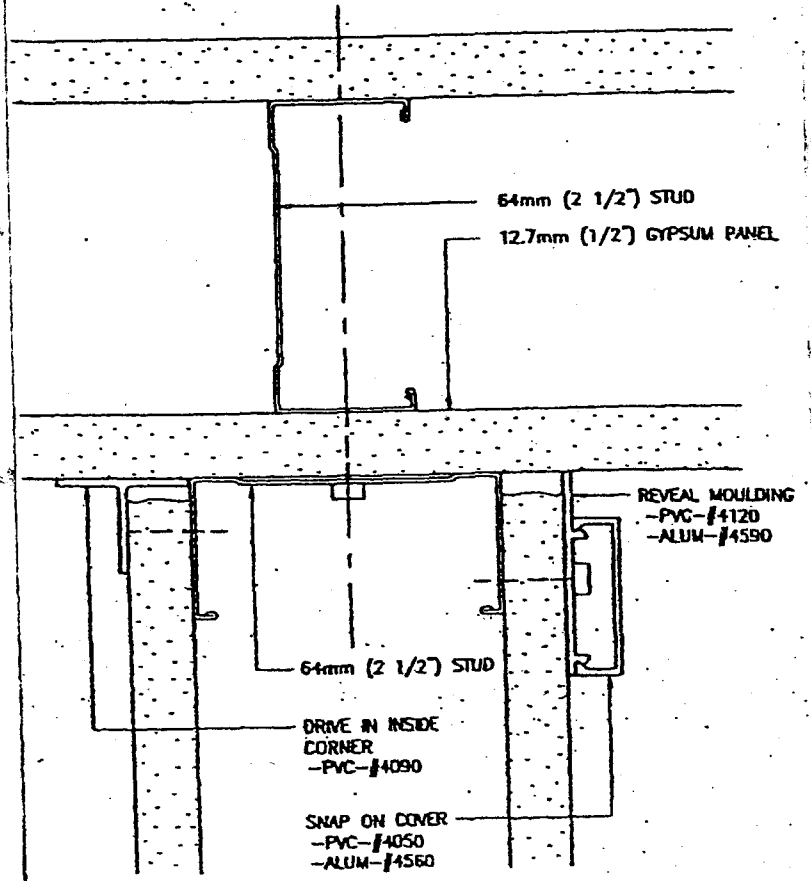

12. END CONDITION

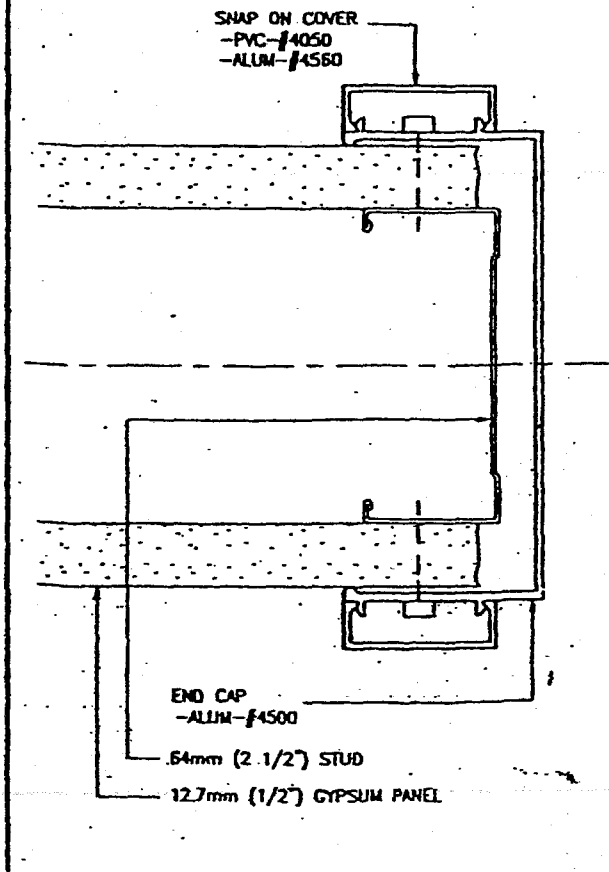

13. BASE

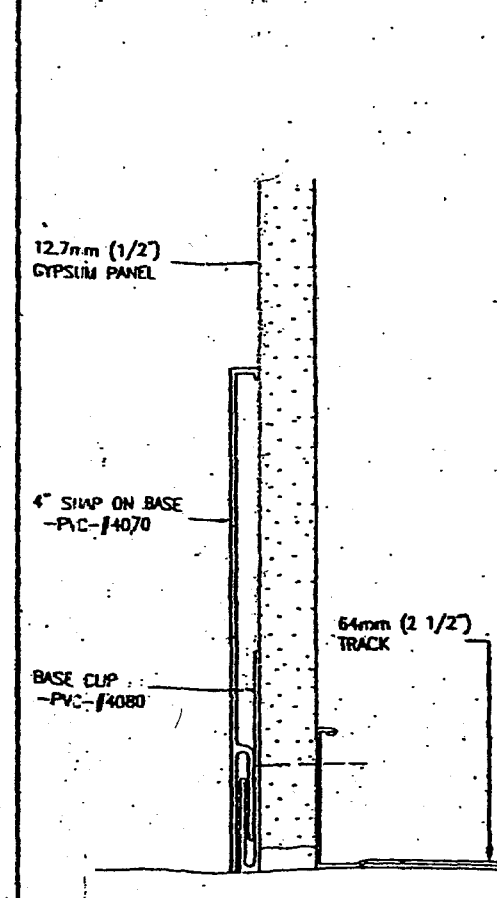

14. BASE/GLAZING DETAIL

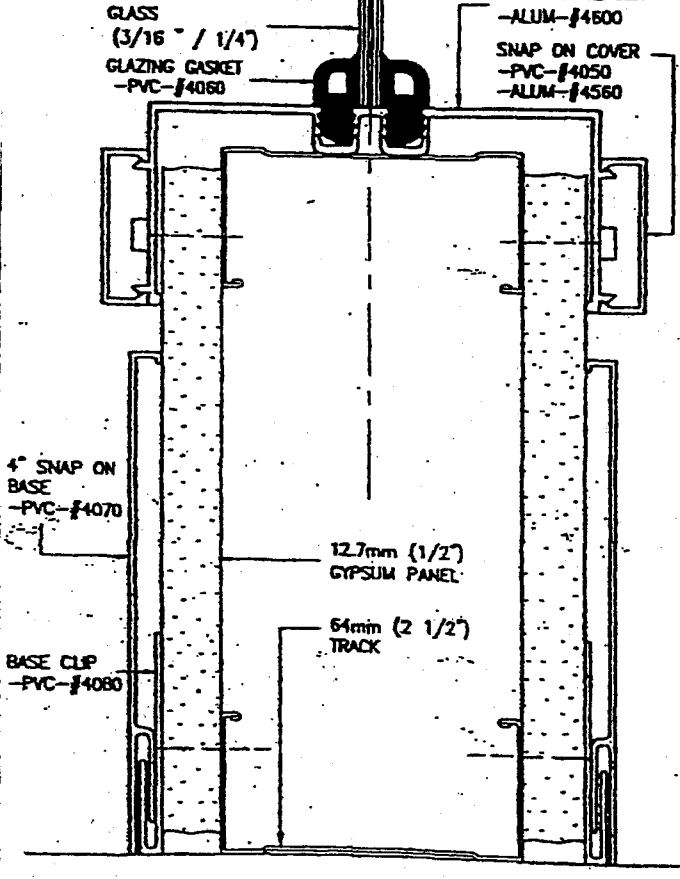

15. LOW SILL

