

TRIM-TEX

Wall Mounted Deflection Bead Installation Instructions

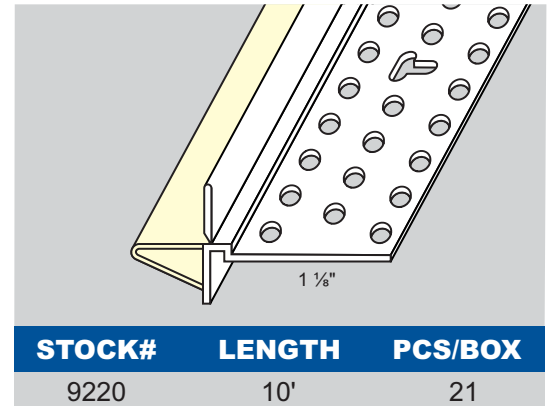

Installation

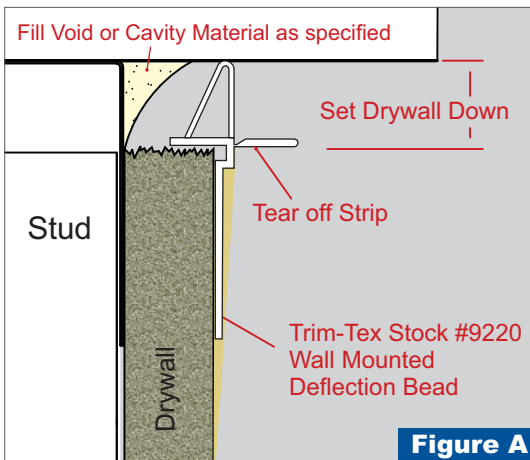

Step 1. Hang your drywall no more than 1/2" from the ceiling.

Step 2. Fill the void shown in **Figure A** with fire caulk or cavity materials specified by the architect.

Step 3. Snip your bead to length and dry fit to the wall creating a seal between the flexible gasket and the ceiling. The Deflection bead is designed to withstand up to 7/16" of deflection.

Method 1. Install the bead with 847 Spray Adhesive and staple the mud leg with 1/2" divergent staples every 6-8". Apply mud compound and prior to the final sanding remove the tear off strip for a clean and crisp finish.

Method 2. Install your bead with a compound tube or blade/trowel. Place your bead into place. Once in position, use the handle of your taping knife to pressure the mud legs to the drywall allowing the excess mud to escape. No need to wipe down the bead if you are applying the fill coat that same day.

How to Miter an Inside Corner



For an inside 90° miter, snip a "V" notch into the tear off strip.



Next, flip the bead over and snip the mud leg all the way through the mud bump and into the back of the gasket.



Make sure the front of the gasket is not snipped and bend the bead to ensure it forms a nice clean inside corner.

How to Miter an Outside Corner



For an outside 90° miter, snip the mud leg all the way through the mud bump and the tear off strip. Do not snip the gasket.



Next, flip the bead over and notch out the "V" slightly going into the gasket.



Bend your bead to see if the front of the gasket forms a clean outside corner.

Stay Connected

TRIM-TEX
DRYWALL PRODUCTS



www.trim-tex.com • 1-800-874-2333